

# Installation Guide

## Steering wheel control Interface

**CTSMT004**  
Mitsubishi Colt 2009>  
(Non Amplified Vehicles)



1

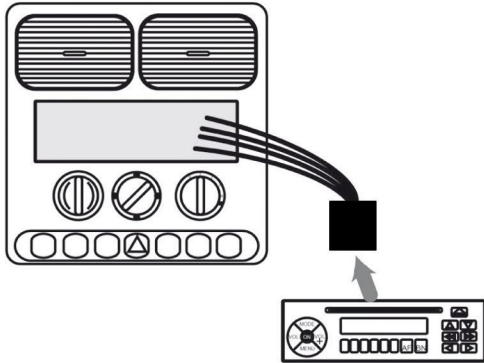

2

Connect aftermarket patch lead to aftermarket head unit. Connect the other end to the interface

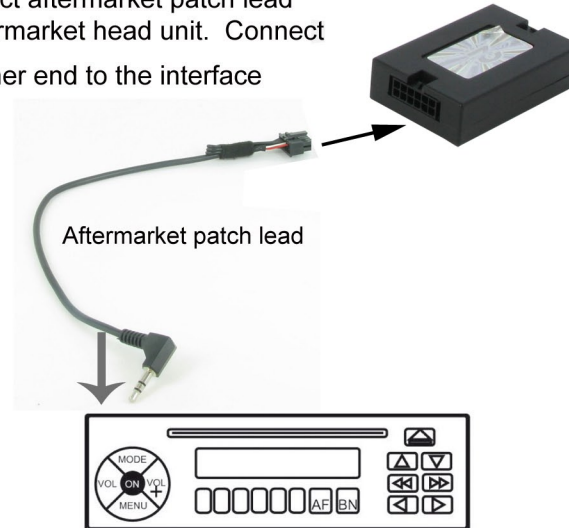

3

Connect the 14 way connector to the interface

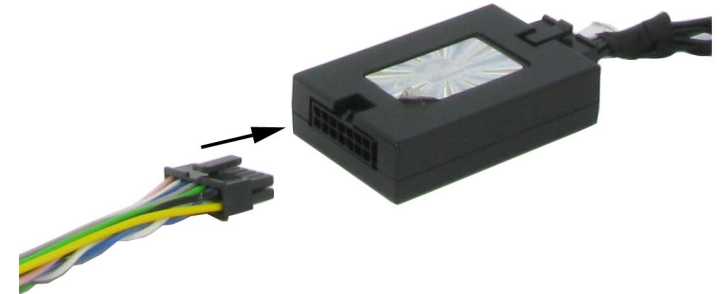

4

Connect the power and speaker ISO plugs to the aftermarket head unit

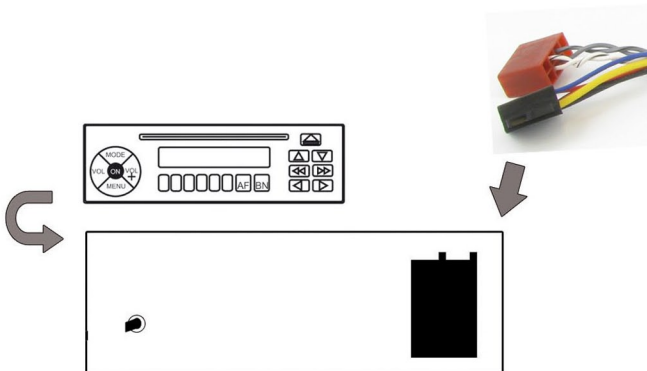

5

Finally, connect the white female Mitsubishi connectors to the corresponding male connectors in the vehicle.

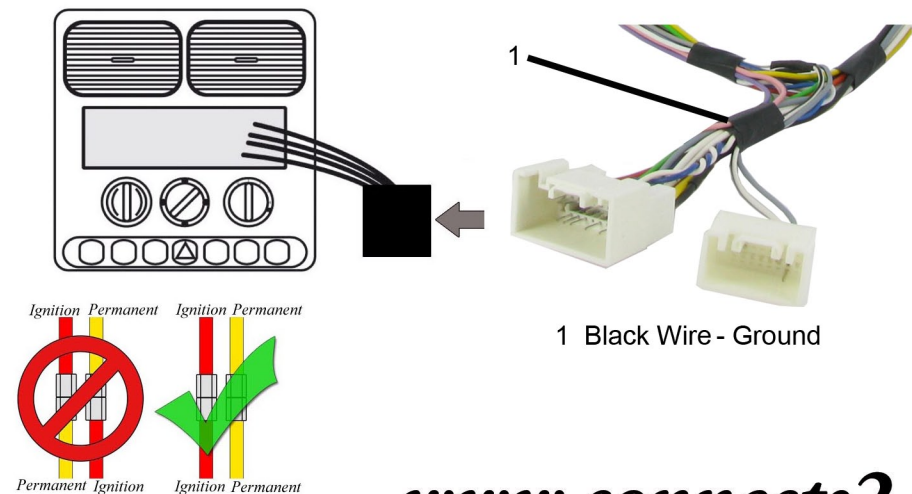

# *Installation Guide*

## *Steering wheel control Interface*

CTSMT004  
Mitsubishi Colt 2009>  
(Non Amplified Vehicles)



### **Trip Computer Settings**

The trip computer can be accessed through the steering wheel controls.

Press  once briefly for source

Press  for 2 Seconds to cycle through trip computer settings. Each 2 second push will enter the next trip computer screen

Press  and hold to reset on any trip computer screen

